

Rev. No.	Revision Note	Date	Signature	Checked
1	Conservation to Fuel & Power - SPRA Recommendations	24-05-04	RCT	

Section Through Parapet Wall

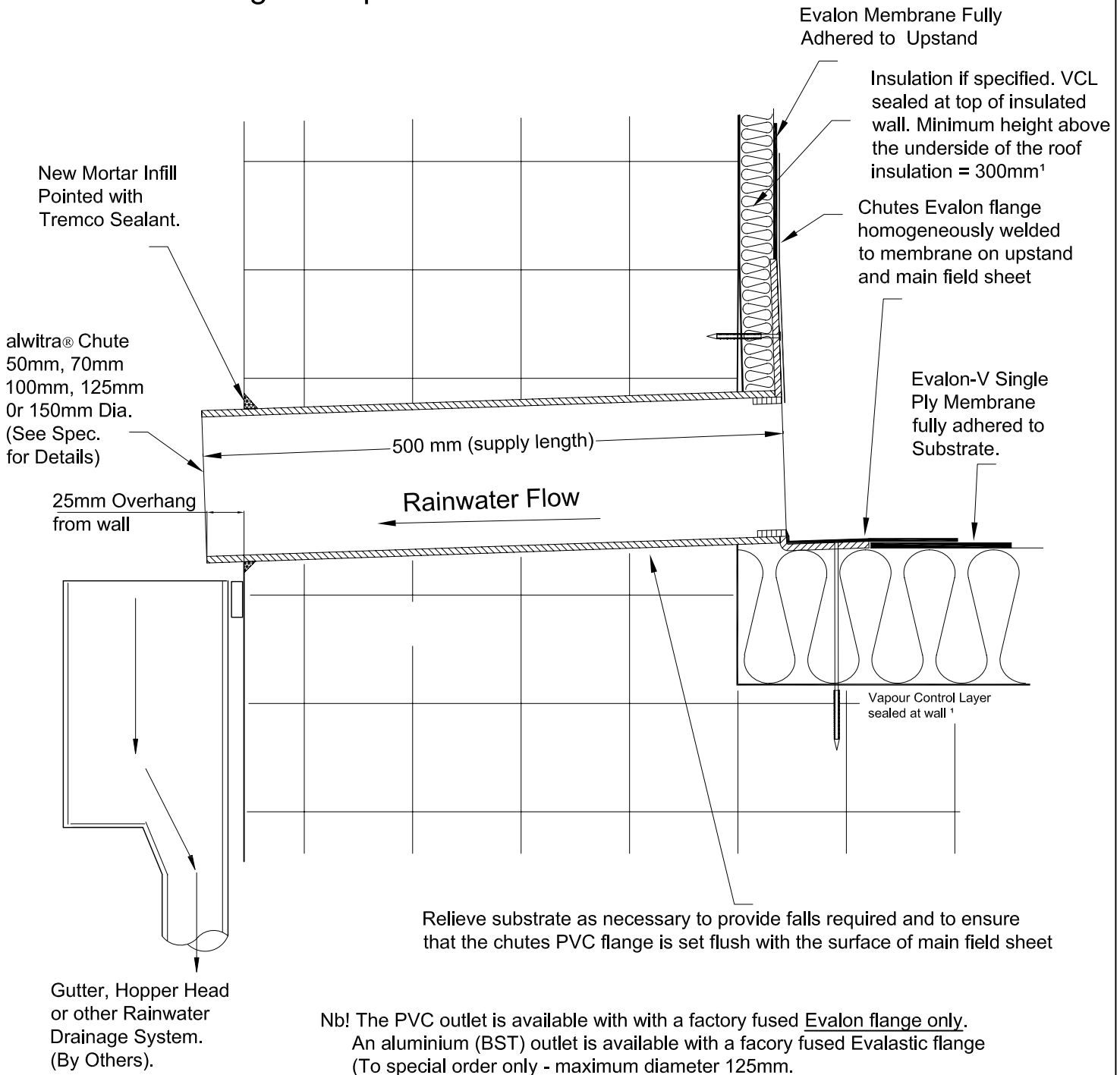

Notes: All Surfaces must be prepared as per ICB Ltd's Written Instructions, and in accordance with the Project Specification. All Adhesives must be used as per the Manufacturers' Instructions.

¹ To avoid thermal bridging, the upstand must be insulated to achieve a minimum thermal resistance (R value) = 0.75m²K/W. This can be achieved by use of insulation as shown above or by other means (e.g. thermal insulation blocks)

Owner



Title/Name

alwitra® Chute through Parapet Wall

Drawing Number

8.5

Drawn By

RCT

Date

01-11-03

Scale

nts